



GUILDCREST ESTATES



Plot 15 St Stephens Park Road

Manston, Ramsgate, CT12 5NE
Prices from £380,000

TURN KEY PROPERTY, READY NOW !!

Last few remaining

THE PENNINGTON

A stunning 3 bedroom semi-detached home, with a light, modern interior.

Step into the light and spacious entrance hall which leads to the open plan kitchen/diner, separate lounge with connecting double doors and downstairs cloakroom. Upstairs you will find 3 bedrooms, an ensuite and the family bathroom.

This property boasts a landscaped front garden, a rear garden laid to turf with an Indian Sandstone patio, single garage and driveway for 2 vehicles.

This stunning new home is all-inclusive, it will be finished and ready for you to move in to, with NO ADDITIONAL COSTS.

This home comes complete with moduleo LVT flooring and luxurious carpet throughout, oak internal doors and a

■ STAMP DUTY PAID

Viewing

Please contact our Manston Office on 01843 272 200 if you wish to arrange a viewing appointment for this property or require further information.



Floor Plan

Area Map

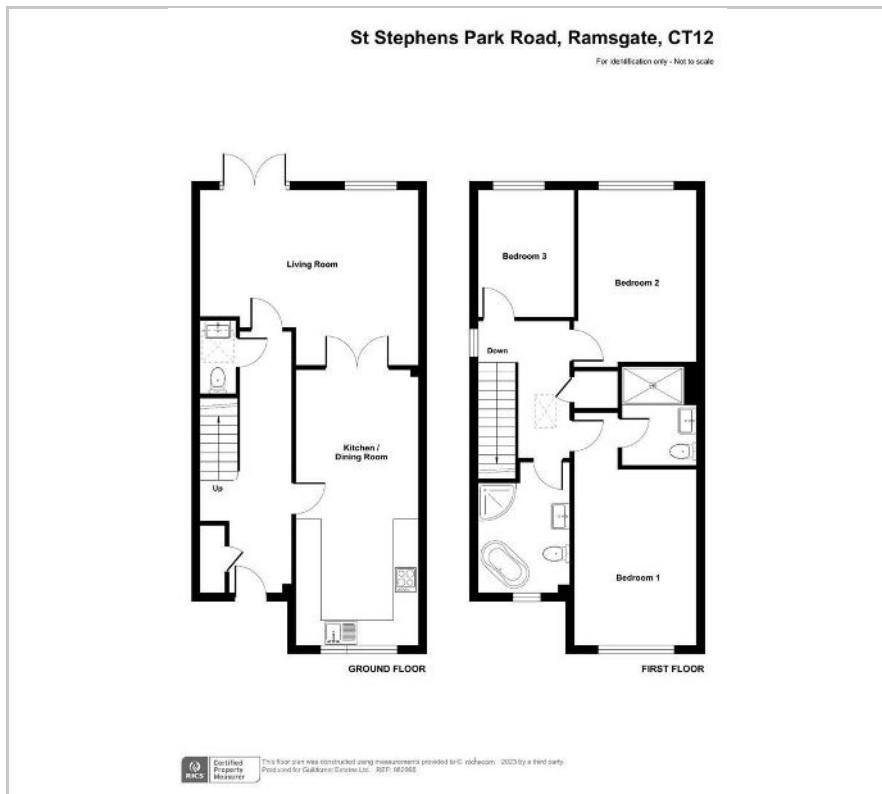

Energy Efficiency Graph

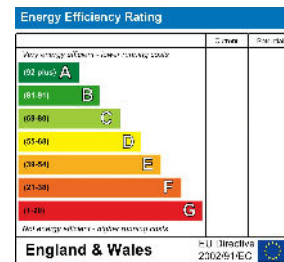

These particulars, whilst believed to be accurate are set out as a general outline only for guidance and do not constitute any part of an offer or contract. Intending purchasers should not rely on them as statements of representation of fact, but must satisfy themselves by inspection or otherwise as to their accuracy. No person in this firm's employment has the authority to make or give any representation or warranty in respect of the property.