



GUILDCREST ESTATES



Unit 2 Merlin Business Park, Manston, Ramsgate CT12 5HW



GUILDCREST ESTATES

Merlin Business Park, Manston,
Ramsgate CT12 5HW

£1,000 + VAT PCM

Incentive Rent Scheme Available

Unlock endless possibilities for your business at Merlin Business Park, located at the heart of Thanet in East Kent just 15 miles from the M2 motorway.

With easy access to the A299 Thanet Way, this prime location provides a link with Ramsgate New Port only 5 miles east, and the site's proximity to the Channel Ports, along with Kent International Airport and high-speed rail links at Thanet Parkway Station, makes it an ideal hub for trade and commerce. Elevate your business to new heights with the unbeatable accessibility and strategic location of Merlin Business Park.

This new light industrial unit boast a sleek steel frame and deep profile composite cladding, making them both low-maintenance and aesthetically pleasing.

With a full mezzanine floor, an electrically-powered insulated door, a separate pedestrian door, and WC, you'll have everything you need to run your business efficiently. Plus, with a spacious forecourt that accommodates parking for up to three cars, you can be sure that your team and clients will always have a convenient place to park.

Usage Class





This unit is classified as B2/B8 (Restrictions apply to motor trade.)

Available April 2026

Annual Service Charge- £400

Rent - £1,000 + VAT pcm

Deposit: Amount to be confirmed, subject to satisfactory credit and reference checks.

Buildings insurance contribution required - £420

Business Rates TBA

Legal Fees apply

Small Business Rate Relief Available

Steel Frame





GUILDCREST ESTATES

Key Features

- Brand New Industrial Unit FOR RENT
- Available Spring 2026
- 2000 SQ FT
- Electric Operated Shutter Roller Door
- Separate Pedestrian Door
- Forecourt-Parking for 3 Cars
- B2/B8 Usage
- Popular Business Park

Important Information

Industrial Unit
 2000.00 sq ft
 EPC Rating B
 £1,000 Per Calendar Month

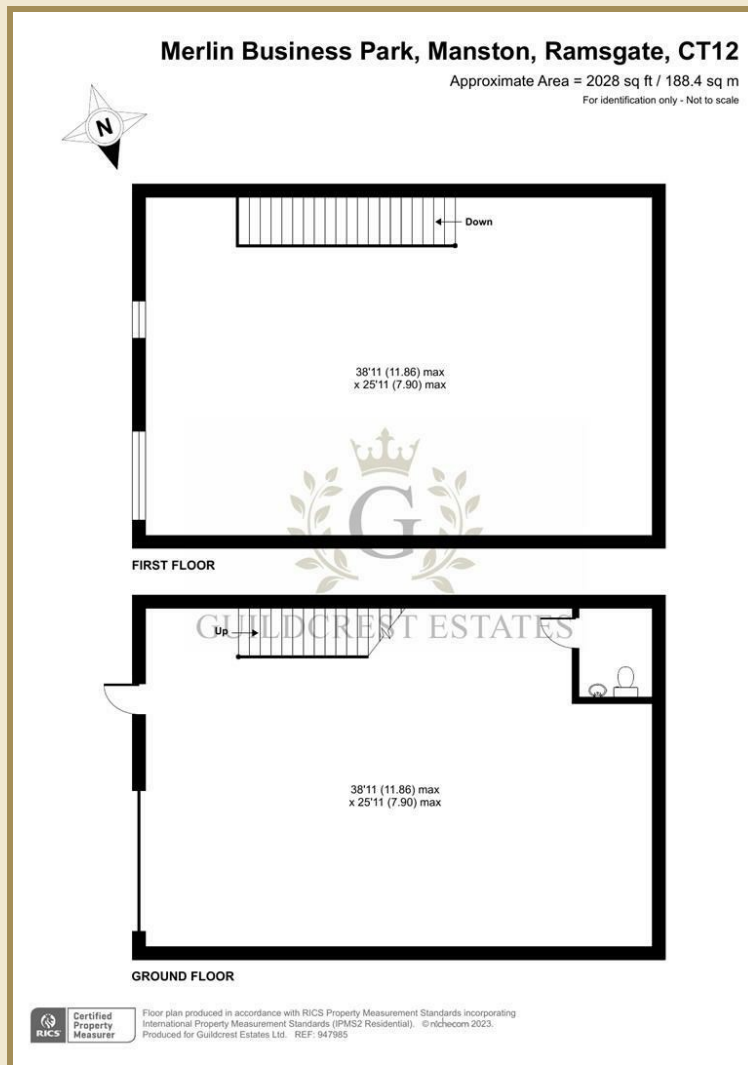

Energy Efficiency Rating		Current	Potential
Very energy efficient - lower running costs			
(92 plus) A			
(81-91) B			
(69-80) C			
(55-68) D			
(39-54) E			
(21-38) F			
(1-20) G			
Not energy efficient - higher running costs			
England & Wales		EU Directive 2002/91/EC	

Environmental Impact (CO ₂) Rating		Current	Potential
Very environmentally friendly - lower CO ₂ emissions			
(92 plus) A			
(81-91) B			
(69-80) C			
(55-68) D			
(39-54) E			
(21-38) F			
(1-20) G			
Not environmentally friendly - higher CO ₂ emissions			
England & Wales		EU Directive 2002/91/EC	



01843 272200 www.guilcrestestates.co.uk

1 The Laurels, Manston Business Park, Ramsgate, Kent CT12 5NQ



Guildcrest Estates Ltd. Registered Office 1 Percy Road, Broadstairs, Kent CT10 3LB Company Number: 13136084 Registered In England & Wales | VAT Number: 374 4288 71

Disclaimer These particulars, whilst believed to be accurate are set out as a general outline only for guidance and do not constitute any part of an offer or contract. Intending purchasers should not rely on them as statements of representation of fact, but must satisfy themselves by inspection or otherwise as to their accuracy. No person in this firm's employment has the authority to make or give any representation or warranty in respect of the property.